

RT-2200/RT-3700



Type	Number	RH!&&\$#\$	RT-5026-2	RH!&&\$#\$ L
Phase		3	1	3
Output	50Hz	2.2	2.2	2.2
	Kw	60Hz	2.6	2.6
Voltage	50Hz	208-255/360-440	220-240	208-255/360-440
	V	60Hz	220-240	220-265/380-460
Current	50Hz	9.7/5.6	18	9.7/5.6
	Amp	60Hz	21.6	10.7/6.2
Vacuum	50Hz	230	230	230
	mbar	60Hz	220	220
Pressure	50Hz	230	230	230
	mbar	60Hz	220	220
Air Flow	50Hz	5.2	5.2	5.2
	m ³ /min	60Hz	6.2	6.2
Insulation Class		H	H	H
L1		143.5[5.65]	143.5[5.65]	186.5[7.34]
L2		370[14.58]	370[14.58]	413[16.26]

RT-2200/3 & RT-3700/3 series (Blowing)

50Hz _____

60Hz _____

The technical data is based on 1 bar (abs.) free atmosphere and 20° C with Inlet air density 1.2kg/m³, includes 10% variance.

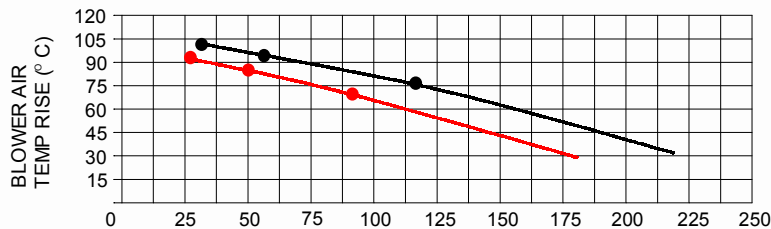
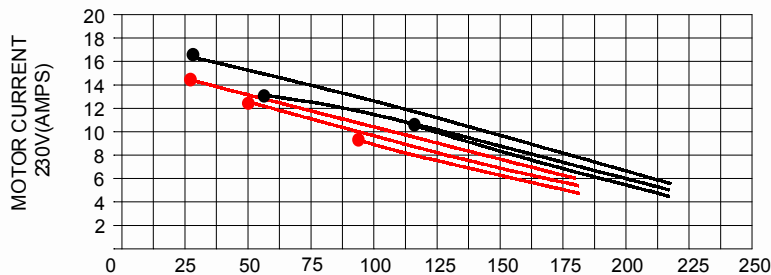
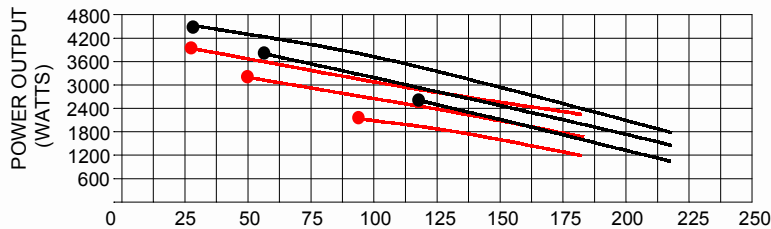
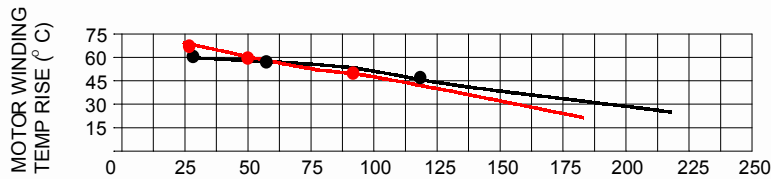
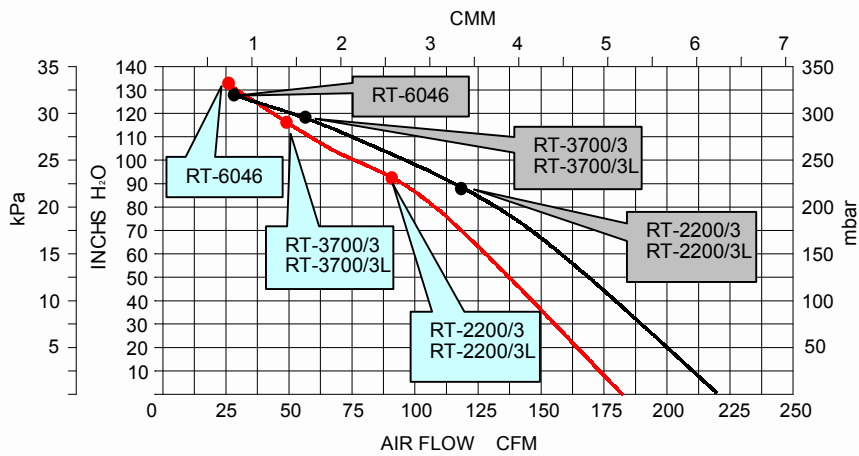

RT-2200/3 & RT-3700/3 series (Suction)

50Hz —————

60Hz —————

The technical data is based on 1 bar (abs.) free atmosphere and 20° C with Inlet air density 1.2kg/m³, includes 10% variance.

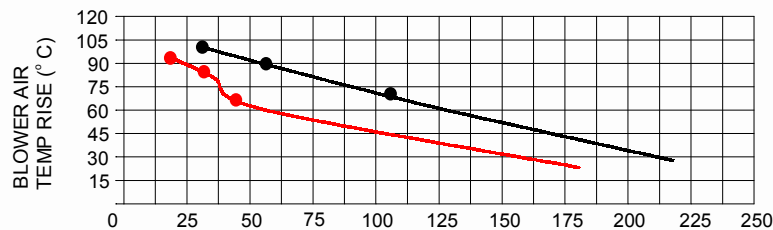
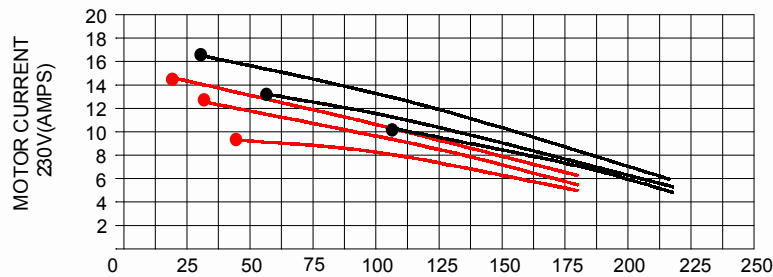
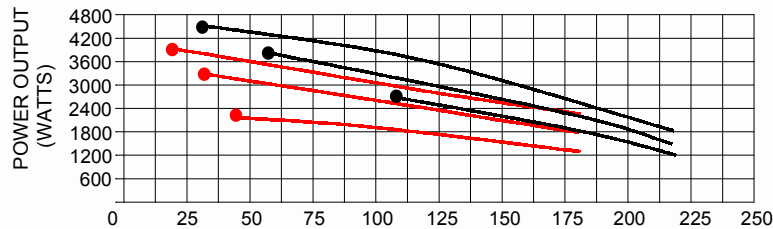
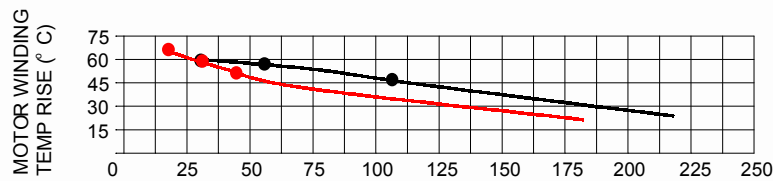
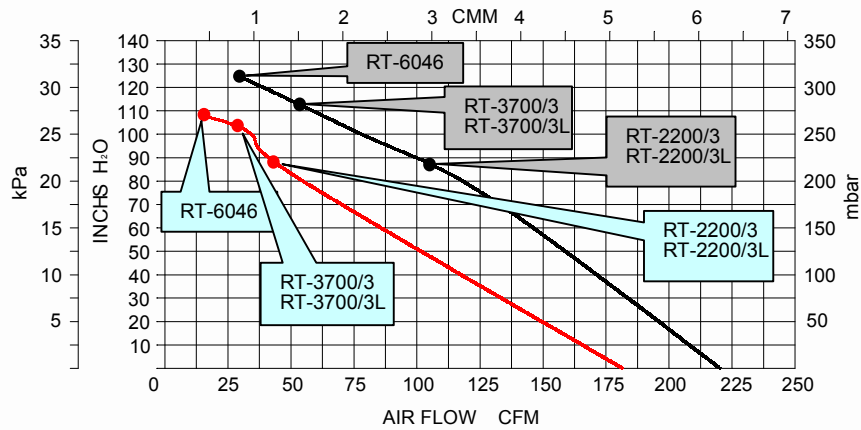

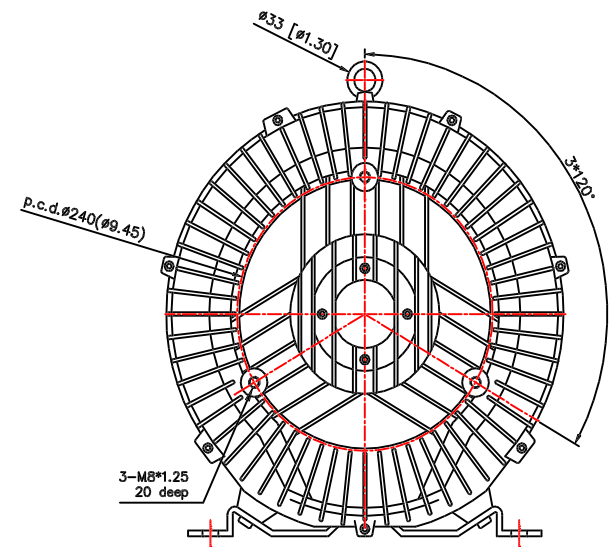
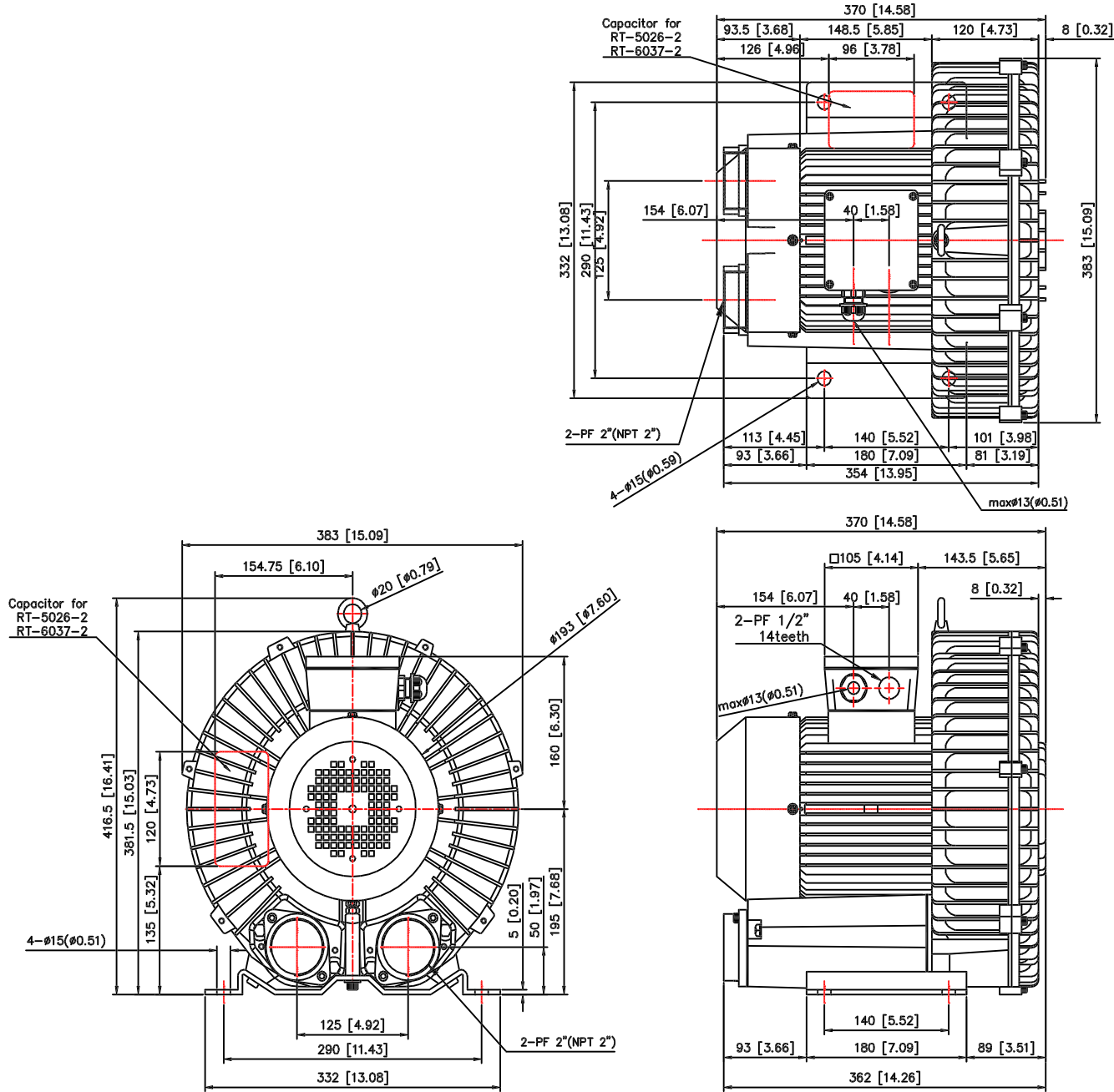

Drawing name : RT-2200 & RT-3700

Airtec Air Systems Ltd

Valley House, Lees Road, Mossley, OL5 0PG, UK

Tel: 01457 832724, Fax:01457 832924

info@airtecairsystems.ltd.uk

